

- Quickly provide positive ID on-site for all volunteers, rescue crews and first responders
- Identify and track assets or skilled professionals
- Accurate reporting for federal reimbursement
- Grant access only to authorized individuals



Secure your incident scene with

***Mobile Event
Manager Solution***

EntryPoint Emergency Event Manager

EntryPoint Emergency Event Manager is a powerful, efficient, mobile management tool that addresses your identification, tracking, and verification of personnel at emergency scenes quickly and securely. It provides emergency responders with improved security, greater risk management and more accountability during an event.

Identify

Provide secure photo IDs on-site for every emergency worker and volunteer. Easily capture data from a driver's license or state issued ID to speed up enrollment, plus attach certifications and other pertinent documents. Issued plastic card credential can contain barcode or any technology of your choice that can be easily scanned at each critical entry point.

Track

Completely mobile, you can easily transport the system from event to event to identify and track emergency workers, volunteers, and rescue crews as well as individual time spent on-site. Reporting is a snap, allowing you to view and export accurate data that can be provided to accounting. Search for attainable assets such as generators, boats or skilled professionals and assign a specific piece of equipment to a specific responder and/or team, easily identifying the responsible individual(s) if not returned after the event.

Manage

EntryPoint Emergency Event Manager allows you to manage personnel contact information, skills and certifications so you always know who you have currently available or what is attainable. Web access gives you the ability to view and access information remotely, allowing you to keep an "eye" on what is taking place at your event.



www.IDentiphoto.com

IDentiphoto[®]
Specialists in IDentification

Identify and Protect with Secure ID Solutions

Feature Highlights

Badging Tracking and Event Management Solution

- Auto notification of assignment duration limit, expired IDs or certifications
- Scan drivers license for fast data entry and positive identification
- Positively ID all emergency workers, volunteers and rescue crews in a disaster area
- Instantly issue ID cards, tags, labels on-site
- Track and manage personnel and volunteer activity
- Interoperable system - allow other departments/organization credentials to be integrated at an event
- Easily identify who is on or off-site
- Integrates with FIPS 201 and PIV solutions
- Easily move from one training or event to the next
- Generate accurate reports quickly for federal reimbursement
- Efficiently search for attainable assets or skilled professionals
- Track personnel and assets away from the command workstation
- Wirelessly transmit data in real time
- Assign responders and assets to groups
- Read 1 and 2-D barcodes, RFID chips, Smart Cards and MOCA cards. Simply scan to track.
- Run reports, manage personnel and assets while viewing data in either real time or while offline
- Link to any database, file based, server based, LAN/WAN or ODBC/OLE DB in real-time
- Send mass messages via e-mail to a group of people with the ability to schedule re-occurring messages and send a report
- Complete Asset Management Tool

Applications

- Emergency Responder/Volunteer access control
- Time and Attendance for reimbursement
- Resource management
- Emergency mustering - who is checked-in
- Truck / delivery access control
- Equipment tracking
- Track supply usage
- Compliance or audit requirements

Options Include

- Mobile Command Case with Built-In PC
- Handheld PC's - for remote verification and tracking
- EntryPoint Clinic Manager
- Wireless Network

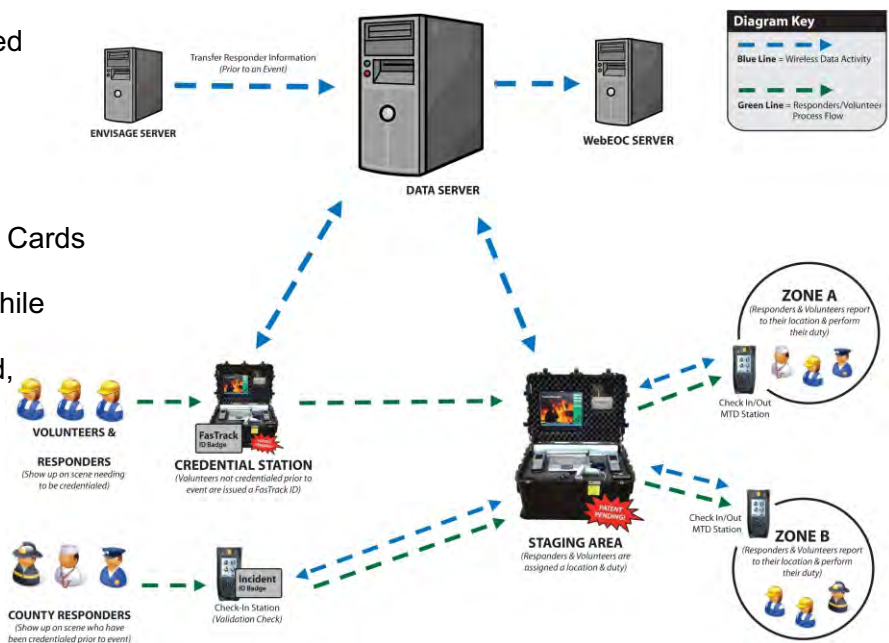

IDentiphoto®

Specialists in IDentification

1810 Joseph Lloyd Pkwy.
Willoughby, OH 44094
Phone: (800) 860-9111
Fax: (440) 306-9001

e-mail: sales@IDentiphoto.com
IDentiphoto.biz • IDentiphoto.com

powered by:

Mobile Solutions

Contact IDentiphoto today at 800-860-9111 to learn about
EntryPoint - Emergency Event Manager.

Incident Scene Total Control