

Cleaning the printer

Run a cleaning card and change the cleaning sleeve when changing the print ribbon. Make sure that all cards sent to the printer have completed printing before cleaning.

- 1 Open the printer cover (1).
- 2 Remove the replaceable cleaning roller and the ribbon cartridge (2).
- 3 Open the input hopper cover (3).
- 4 Remove unprinted cards from the input hopper (4).
- 5 Open the cleaning card package and remove the cleaning card.



- 6 Insert the cleaning card into the input hopper (5), just past the roller.
- 7 On the LCD panel, press the Enter key to view the Main Menu.
- 8 Press the Up Arrow or Down Arrow key to display "Diagnostics" and then press the Enter key.

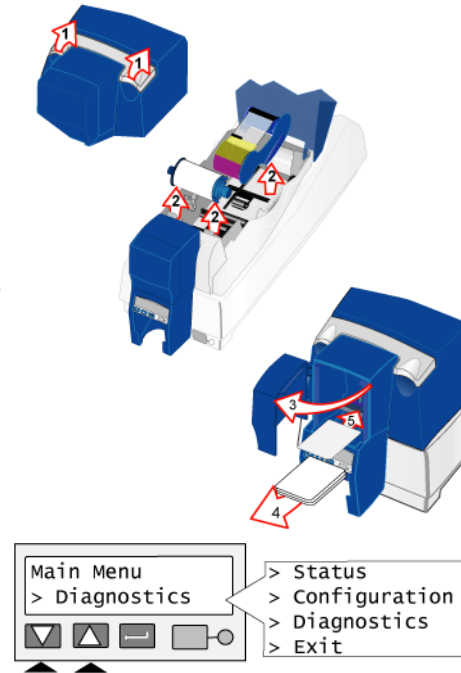

- 9 Make sure "> Cleaning Card" is displayed on the second line of the LCD panel and press the Enter key.

The printer moves the card through the printer several times and ejects the card. Wait a few minutes to allow the rollers to dry for best printer operation and print quality.

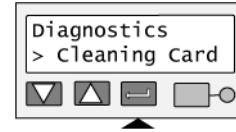

- 10 Slide the used cleaning sleeve off the spindle.
- 11 Discard the used cleaning card and used sleeve.
- 12 Place a new cleaning sleeve on the spindle (1).
- 13 Remove the protective cover from the sleeve (2).
- 14 Insert the replaceable cleaning roller (with a new cleaning sleeve) into the printer (3).
- 15 Replace the ribbon cartridge, close the printer cover, load cards, and resume printing.

Cleaning tips

- Use the cleaning card as soon as you open the package. The cleaning solution on the card evaporates after a few minutes.
 - Some card features, such as signature panels and magnetic stripes, can require more frequent cleaning of the printer.
 - If you use StickiCards™, use a cleaning card more often, such as after printing every 100 cards. The printer might also need additional cleaning. See "Cleaning the printer rollers" on page 41.
-

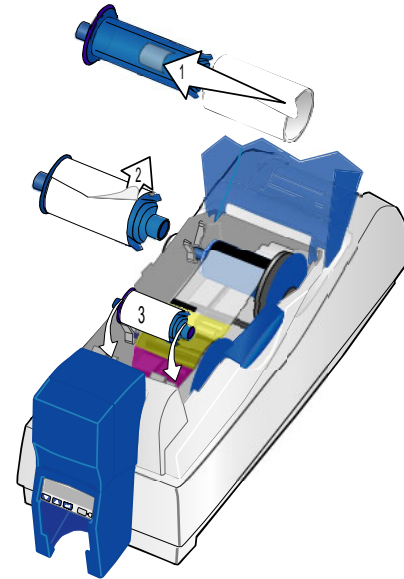

Cleaning the printer rollers

The printer rollers move the card during printing operations. Clean the rollers, using the cleaning pen supplied with the printer, when problems occur such as:

- Repeated card jams
- Cards are not being picked, repeatedly
- Colors are not aligned on the printed card

1 Clean the pick roller:

- a Open the input hopper and remove all cards from the input hopper.
 - b Remove the cap from the cleaning pen. Hold the end of the cleaning pen against the pick roller.
 - c Use the LCD panel to run a cleaning card. See “Cleaning the printer” on page 39. Do not insert a cleaning card! The printer moves rollers when it attempts to pick the card.
 - d Move the cleaning pen over the surface of the pick roller.
 - e Lightly wipe any dirt from the end of the cleaning pen onto a clean cloth or paper. Move the cleaning pen to another area of the roller.
 - f Repeat steps c through e until no more dirt appears on the pen.
- 2 Clean the permanent cleaning rollers (at location 1) following the same procedure used for the pick rollers.

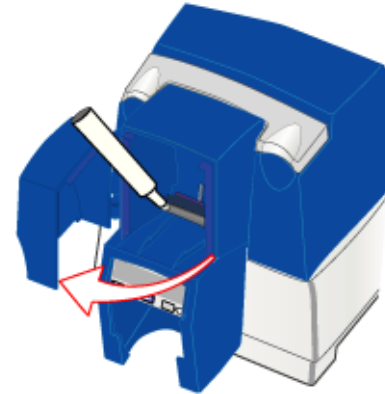

- 3 Clean the transport area rollers (at locations 2, 3, 4, 5, and 6) following the same procedure used for the pick rollers.
 - Wait a few minutes to allow the rollers to dry for best printer operation and print quality.
- 4 Replace the print ribbon cartridge and cleaning roller. Close the printer cover.
- 5 Replace cards in the input hopper.
- 6 Print a card to verify the quality of printing.

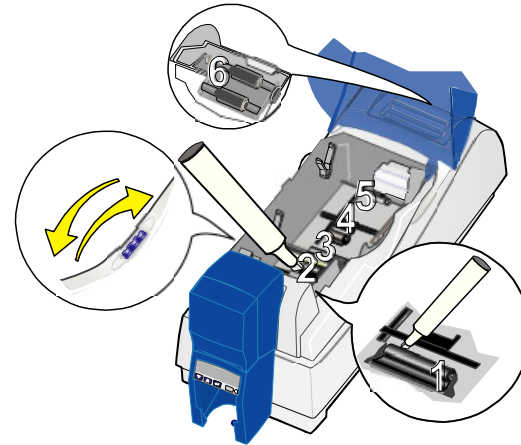

IDentiphoto[®]

Specialists in IDentification

1810 Joseph Lloyd Pkwy.

Willoughby, OH 44094

Phone: (800) 860-9111

Fax: (440) 306-9001

e-mail: sales@IDentiphoto.com

web: www.IDentiphoto.com